

**Test 1: The arguments are:**

- An *rg.Square*
  - centered at `rg.Point(125, 50)`
  - with length of each side 60
  - fill color 'red'
  - outline color 'blue'
- A *thickness* 6
- An *rg.RoseWindow* that is 400 x 250

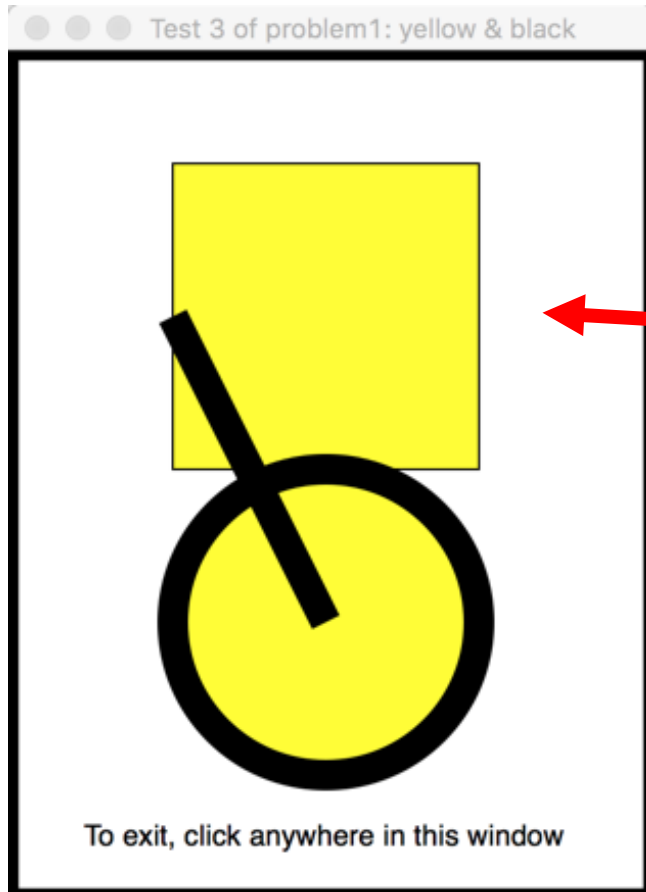
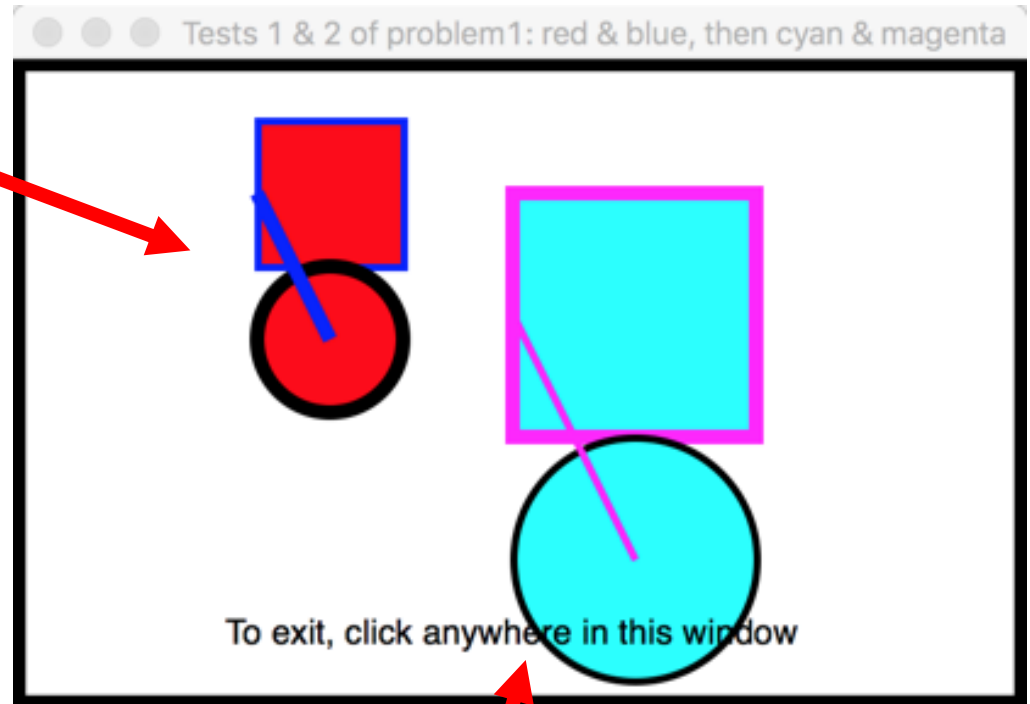

**Test 3: The arguments are:**

- An *rg.Square*
  - centered at `rg.Point(150, 125)`
  - length of each side 150
  - fill color 'yellow'
  - outline color 'black'
- A *thickness* 15
- An *rg.RoseWindow* that is 300 x 400

**Test 2: The arguments are:**

- An *rg.Square*
  - centered at `rg.Point(250, 100)`
  - with length of each side 100
  - fill color 'cyan'
  - outline color 'magenta'
- A *thickness* 3
- An *rg.RoseWindow* that is 400 x 250